

Quick Start Guide

F34

Version: 1.0

1. Overview

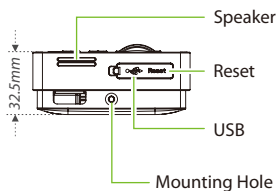
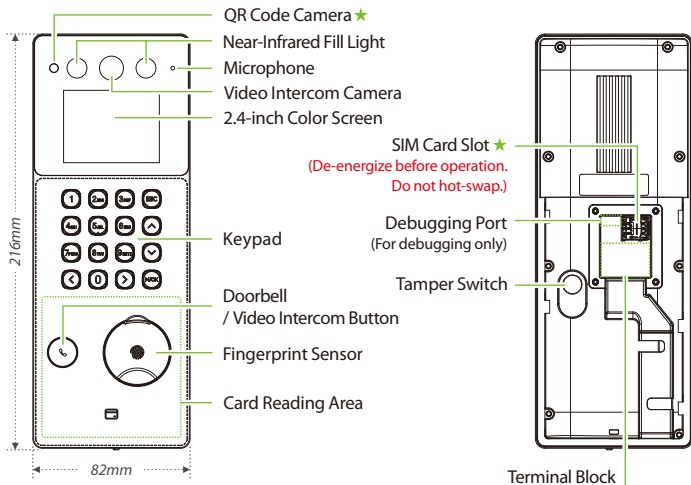

Note: Not all products have the function with ★, the real product shall prevail.

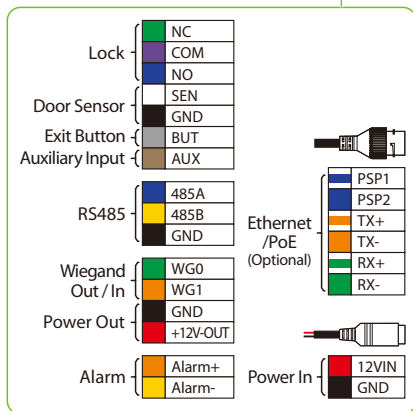

2. Installation Environment

Please refer to the following recommendations for installation.



KEEP DISTANCE



AVOID GLASS
REFRACTION



AVOID DIRECT
SUNLIGHT
AND EXPOSURE



AVOID USE OF
ANY HEAT SOURCE
NEAR THE DEVICE

3. Device Installation

- ① Stick the mounting template sticker to the wall and drill holes according to the mounting template sticker.
- ② Fix the backplate on the wall with the wall mounting screws.
- ③ After passing the wires through the wiring hole and connecting them to the device, and then snap the device onto the backplate and push it down into place.
- ④ Fasten the device to the backplate with a security screw.

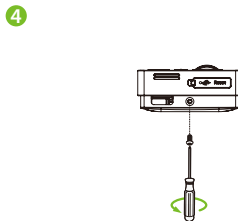
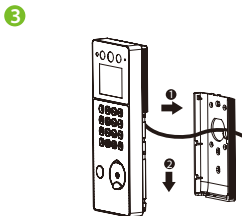
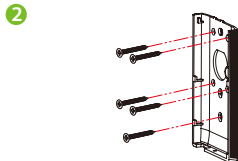
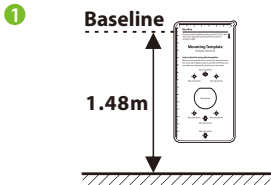

4. Standalone Installation

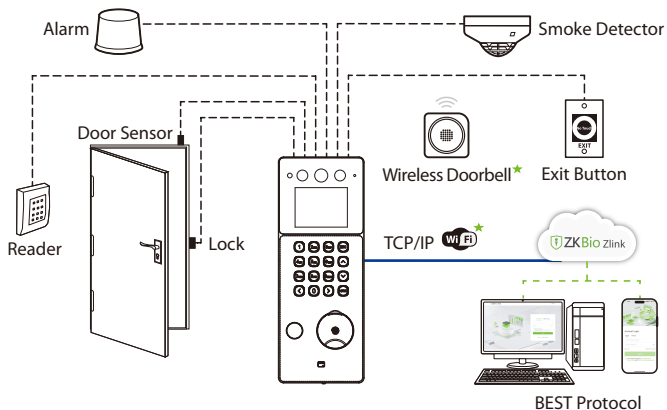

5. Power Connection

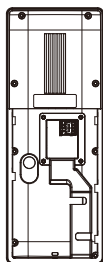

Method 1: PoE Connection ★



Method 2: AC Adapter Connection



Note: When PoE is supplying power externally, there are power consumption limits for the electric lock. It is recommended that the power consumption not exceed 12V / 0.85A (constant current, including peak current).

6. Ethernet Connection

Connect the device and computer software via an Ethernet cable. As shown in the example below:

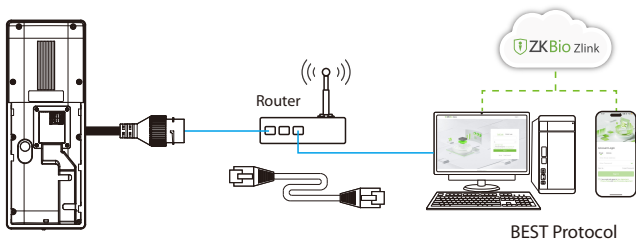

Enter **[COMM.]** > **[Ethernet]** to set the relevant parameters of network.

Notes:

- 1) The device type is **BEST Protocol** by default. You can switch to T&A PUSH to connect to BioTime Cloud/ZKBio Time, or switch to A&C PUSH to connect to ZKBio CVAccess.
- 2) The device needs to access the external network when connecting to ZKBio Zlink / BioTime Cloud.

7. RS485 Connection

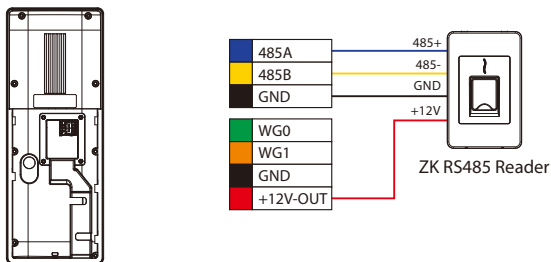

8. Exit Button, Door Sensor, Alarm & Auxiliary Connection

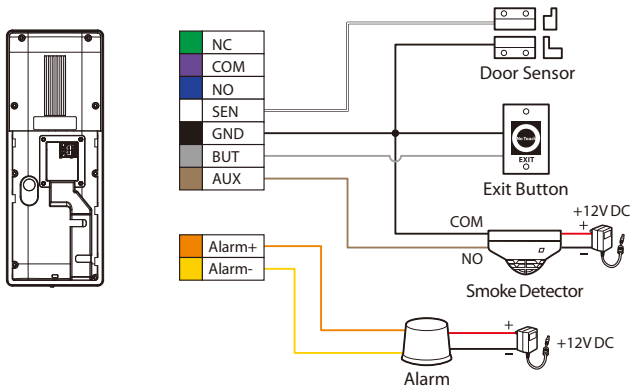

9. Wiegand Connection

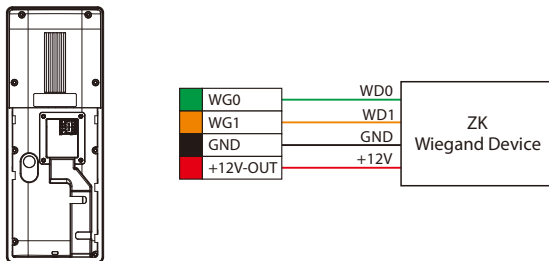

Note: The Wiegand interface is shared, and the user can choose to use either the Wiegand input or Wiegand output function to interface with different Wiegand devices.

10. Lock Relay Connection

The system supports both **Normally Opened Lock** and **Normally Closed Lock**. The **NO LOCK** (normally opened at power on) is connected with 'NO' and 'COM' terminals, and the **NC LOCK** (normally closed at power on) is connected with 'NC' and 'COM' terminals. Take NC Lock as an example below:

1) Device not sharing power with the lock



 Do not reverse the polarity.

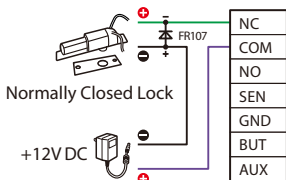

 Maximum 30V 3A input.

2) Device sharing power with the lock

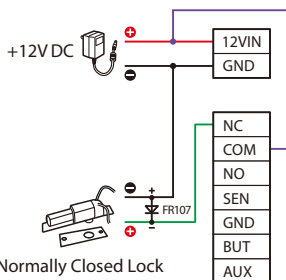

Note: Tested with an electric mortise lock rated at 0.35A or 0.65A and 12V. If the current exceeds these values, power consumption limitations apply to the electric lock, it is recommended not to exceed 12V / 1.8A.

11. Connect the Wireless Doorbell ★

This function needs to be used with the wireless doorbell.

First, power on the wireless doorbell. Then, press and hold the music button  for 1.5 seconds until the indicator flashes to indicate it's in pairing mode. After that, press the doorbell button on the device, if the wireless doorbell rings and the indicator flashes, it means the pairing was successful.

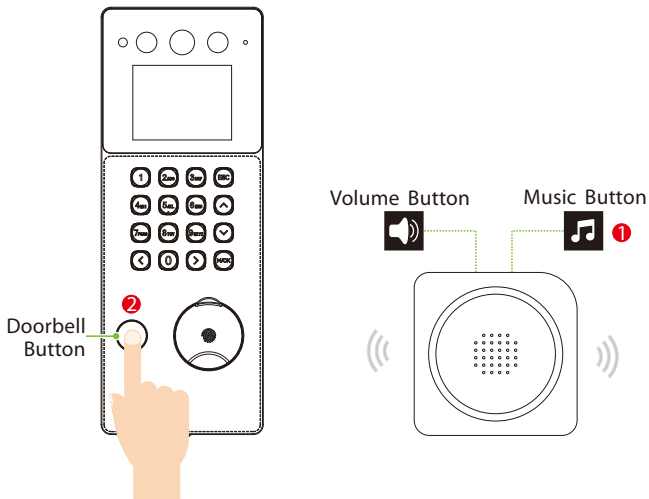

After a successful pairing, press the doorbell button on the device will ring the wireless doorbell.

Notes:

- 1) Each device only supports one wireless doorbell.
- 2) Wireless doorbell needs to be purchased by the customers themselves.

13. Ethernet and Cloud Server Settings

Press **[M/OK]** and enter **[COMM.]** > **[Ethernet]** to set the network parameters. If the TCP/IP communication of the device is successful, the icon  will be displayed in the upper right corner of the standby interface.

Press **[M/OK]** and enter **[COMM.]** > **[Cloud Server Settings]** to set the server address and server port. For example, set the IP address and port number of the server after the software is installed. If the device communicates with the server successfully, the icon  will be displayed in the upper right corner of the standby interface.

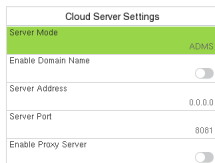
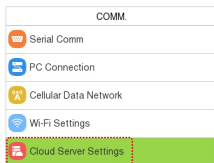
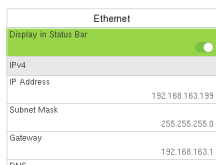
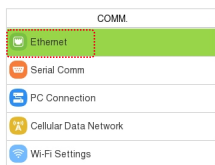
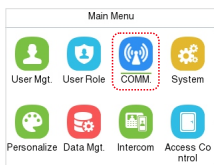

Notes:

- 1) The **Cloud Server Settings** menu only appears when the device type is **PUSH Protocol**.
- 2) During the process of pairing the device with the ZKBio CVAccess/ZKBio Time software.

Server Address: Set as the IP address of the ZKBio CVAccess/ZKBio Time.

Server Port: Set as the Adms service port of ZKBio CVAccess/ZKBio Time.

- 3) When pairing the device with the BioTime Cloud software, you need to enable Domain Name and enter the correct server address.

14. Cellular Data Network★

Remove the back plate of the device and insert the SIM card★ in the location shown in the figure below. Then select **[Cellular Data Network]** on the **[Comm.]** interface to enter the setting interface. When the mobile network is connected successfully, the initial interface will display the mobile network ^{4G} logo.

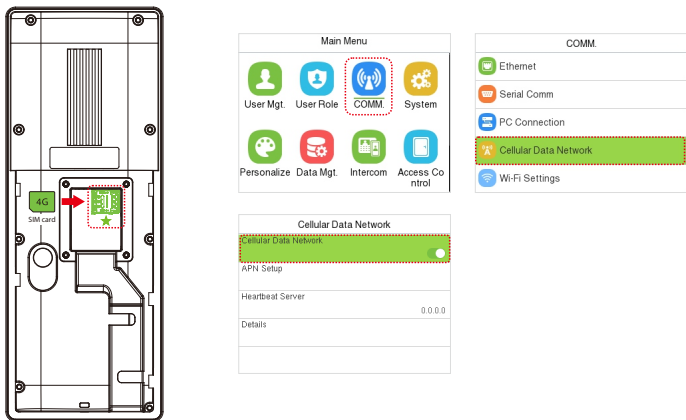

Notes:



- 1) De-energize before operation. Do not hot-swap.
- 2) To use the cellular data network function, the device must be connected to an external power supply. Additionally, while connected to an external power supply, you must manually enable the cellular data network function.

15. Connect to ZKBio Zlink App

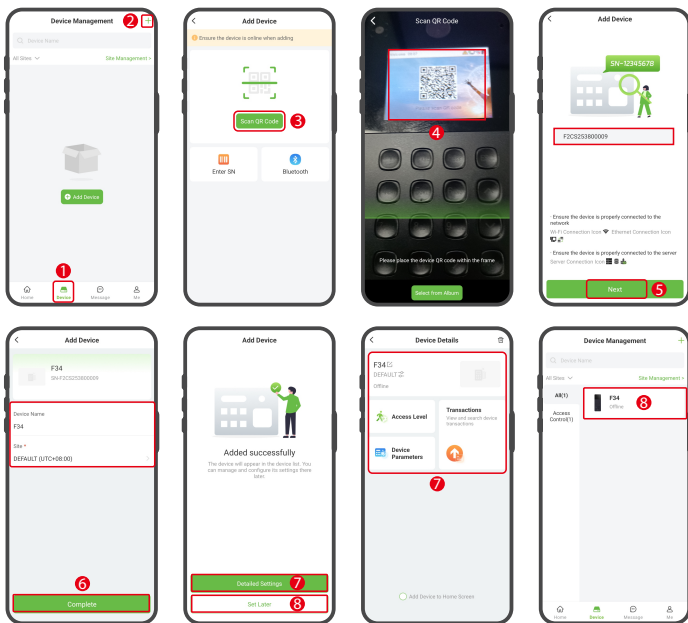
1. Access the ZKBio Zlink App and click on **[Device]** > the **+** icon in the top-right corner to access the "Add Device" screen. (See diagram step 1,2)
2. Then click **[Scan QR Code]** to scan the QR code on the device. After scanning the QR code to find the device, click **[Next]**. (See diagram step 3,4,5)
3. Enter the device name and specify the device to a site. Click **[Complete]** to complete the addition. (See diagram step 6)
4. Once successfully added, the device is displayed in the list of the device interface. Click **[Detailed Settings]**/**[Set Later]** to enter the corresponding interface. (See diagram step 7,8)



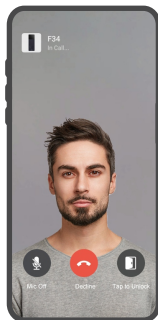
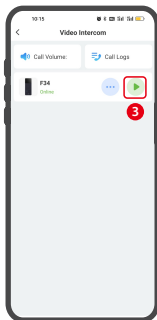
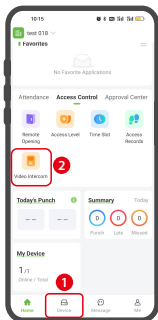

● Video Intercom Settings

1. Access the ZKBio Zlink App and click on **[Device]** > **[Video Intercom]**, then click the  icon to call this device. Tap the “Tap to Unlock”  icon to remotely unlock the door.

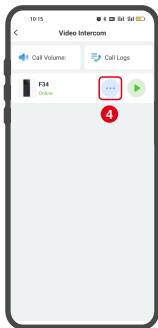

2. Tap the  icon to enter the intercom settings interface. Click **[Mobile App]** > **[Add]** to link personnel who can answer incoming calls via the app.



3. After completing the setup, press the video intercom button  on the device. In the pop-up interface, enter the call number or press the **UP** key to open the contact list and search for the person you wish to call. Then press the **M/OK** button to initiate the call.

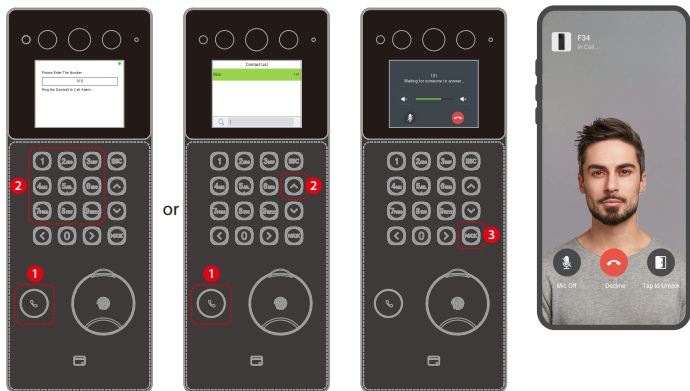

● View Records

Employee access records can be viewed in the **[Transactions]** section of the device details interface.

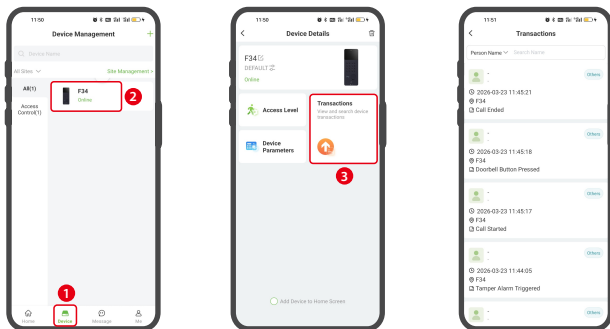

16. Connect to ZKBio Zlink Web

1. Access the ZKBio Zlink Web and click the  icon on the top left corner, and click **[Device Center]** > **[Device]** > **[+Add Device]** to enter the Add Device interface.

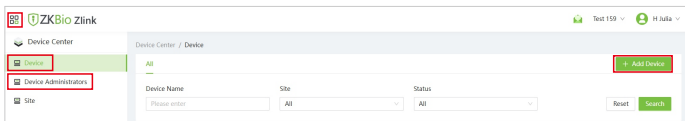

2. Enter the Serial Number of the device and click **[Search]**.

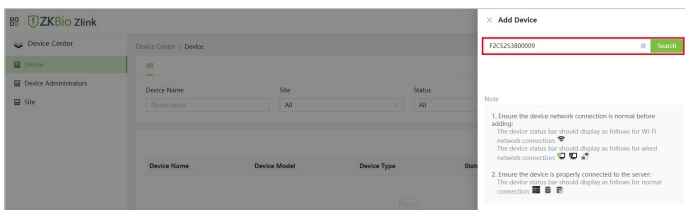

3. Then enter the device name and specify the device to a site. Click **[Save]** to complete the addition.

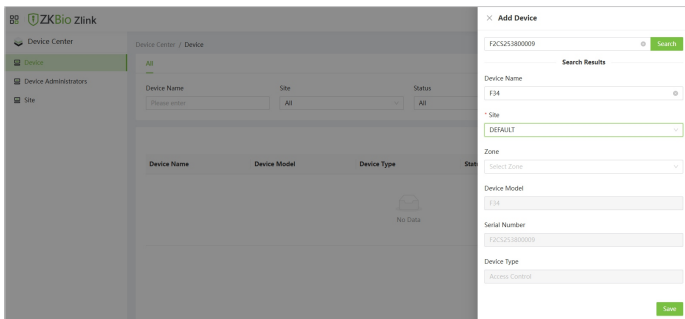

For other specific operations, please refer to the *ZKBio Zlink User Manual*.

17. SIP Settings

The device achieves video intercom there are two modes, respectively, the **LAN** and **SIP server**.

● Local Area Network Use

In this mode, please make sure that the SIP Server of the device is disabled. This function needs to be used with the indoor monitor VT07-B01.

1. Set the indoor monitor to the same network segment as the device.
2. On the indoor monitor, click **[Setting]** > **[Advance Setting]** > **[Device Manage]** > **[Add]** to add the device.
3. On the device, enter **[Intercom]** > **[SIP Settings]** > **[Contact List]** > **[Add]** to add the connected indoor monitor.

Room Number: Customize the number of the indoor monitor.

Call Address: It is the IP Address of the indoor monitor.

● Enter the Number or IP Address of the Indoor Monitor

Press the  key on the device and enter the Number or IP Address of the indoor monitor in the pop-up interface of the device.

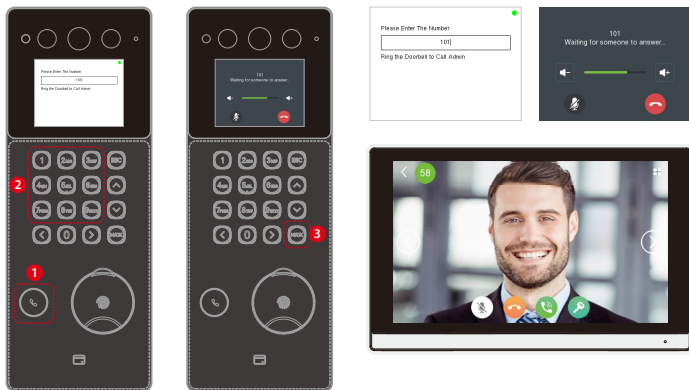

● Call Contact List

1. On the SIP Settings interface, enter [**Local Settings**] to enable the call contact list.

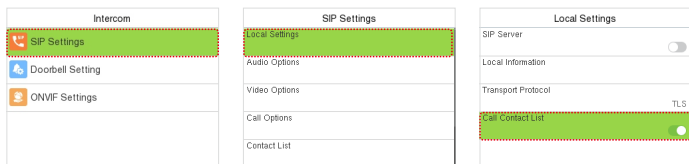

2. Press the  key on the device to enter the call page, then you can press the **Up** key to open the contact list, select the number of the indoor monitor you want to call.



● Calling Shortcut Keys

1. On the SIP Settings interface, enter [**Calling Shortcut Settings**] to enable and define the shortcut keys.

Name: Customize the name of the shortcut keys.

Number: Select the room number that set in the **Contact List** Menu.

SIP Settings
Video Options
Call Options
Contact List
Calling Shortcut Settings
Advanced Settings

Calling Shortcut Settings	
Management Center	Disable
Call Mode	Standard Mode
ROOM1	Disable
ROOM2	Disable
ROOM3	Disable

Number : 102	
Enable	<input checked="" type="checkbox"/>
Name	ROOM1
Number	102

- Press the  key on the device and click **Down** key to select the calling shortcut keys to call the indoor monitor.

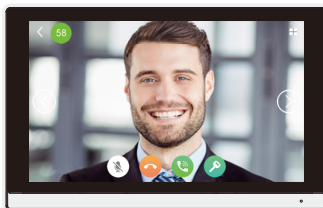
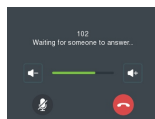

● Direct Calling

- On the SIP Settings interface, enter [**Calling Shortcut Settings**] > [**Call Mode**] > [**Direct Calling Mode**] > [**Add**]. Select the indoor monitors that you want to call, then the indoor monitors will be displayed in the list.

Calling Shortcut Settings
<input type="radio"/> Standard Mode
<input checked="" type="radio"/> Direct Calling Mode

Calling Shortcut Settings	
Management Center	Disable
Call Mode	Direct Calling Mode
Add	

Contact List
<input type="checkbox"/> 101
<input type="checkbox"/> 102
<input checked="" type="checkbox"/> 103
<input type="checkbox"/> 104

2. Press the  key on the device to call the indoor monitors directly.



● SIP Server

In this mode, please make sure that the SIP Server of the device is enabled. This function needs to be used with the ZKBio CVAccess server, ZKBio Zexus Mobile App, indoor monitor VT07-B26L-W / VT07-B22L and PC Client BioTalk Pro.

There are 2 kinds of SIP server: **Cloud SIP** and **PBX server**. Here take **Cloud SIP** as an example.

1. On the ZKBio CVAccess software, click [**System**] > [**System Management**] > [**Cloud Settings**] to enable the Cloud SIP service. Click **ZKBio CVConnect Client** to download and install it. (**Note:** The specific installation and activation steps of the client can refer to *ZKBio Zexus Mobile App User Manual*.)

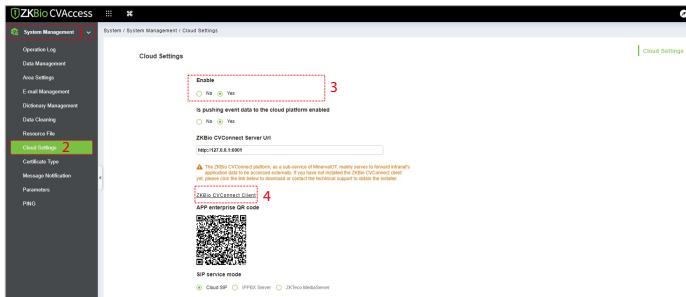

2. Add the device to the **Access** Module of the software. Then the device will be automatically synchronized to the **Video Intercom** module.

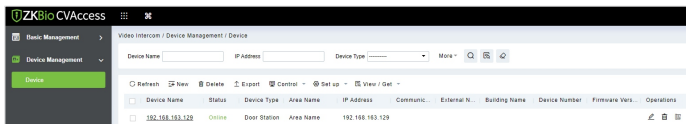

3. Click **[Video Intercom] > [Extension Management] > [Extension Number] > [New]** to add the extension numbers.

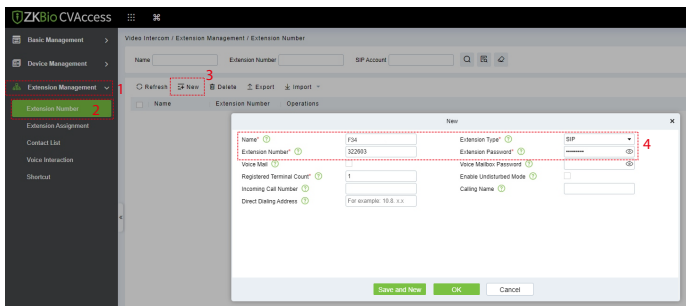

4. Click **[Contact List] > [New]** to add the contacts. Then click the icon to add extension numbers to it.

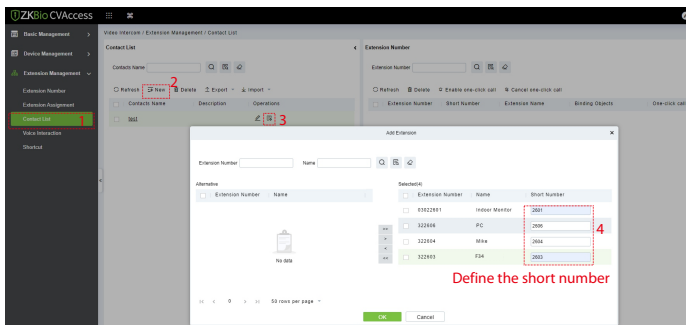

- Click **[Extension Assignment]** > **[Extension Assignment]** to assign an extension number and synchronize the contacts to the device.

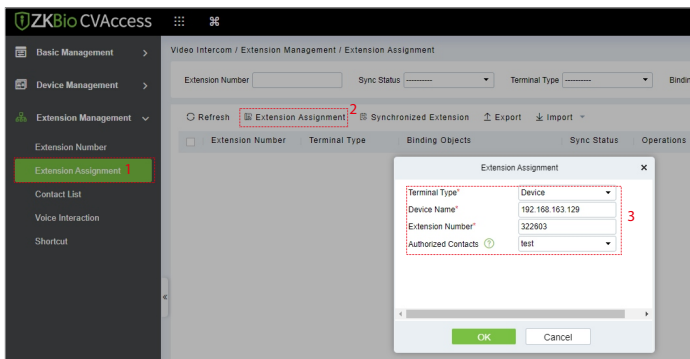

- Once the SIP is set up correctly, a green dot will appear in the upper right corner of the call page, indicates that the device is connected to the server.

● Device Call the Indoor Monitor (VT07-B26L-W / VT07-B22L)

- On the ZKBio CVAccess software, click **[Video Intercom]** > **[Device Management]** > **[Device]** > **[New]** to add the indoor monitor. Then assign an extension number to the indoor monitor.
- Press the **[📞]** key on the device to enter the call page, enter the Short Number of the indoor monitor, or press the **Up** key to open the contact list, select the indoor monitor you want to call.

Note: Enter **[Intercom]** > **[SIP Settings]** > **[Local Settings]** > **[Call Number Type]**, select the call number type as **Room Number**.

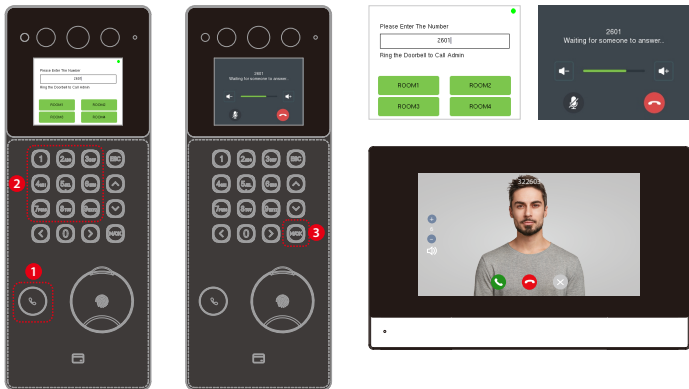

● Device Call the Phone (ZKBio Zexus App)

1. On the ZKBio CVAccess software, assign an extension number to the personnel.
2. Press the ☎ key on the device to enter the call page, enter the Short Number of the personnel, or press the **Up** key to open the contact list, select the personnel you want to call.



● Device Call the PC Client (BioTalk Pro)

1. Install the BioTalk Pro software and configure the SIP account. (The SIP account is created in the ZKBio CVAccess.)
2. Press the  key on the device to enter the call page, enter the Short Number of the PC client or press the **Up** key to open the contact list, select the PC client you want to call.

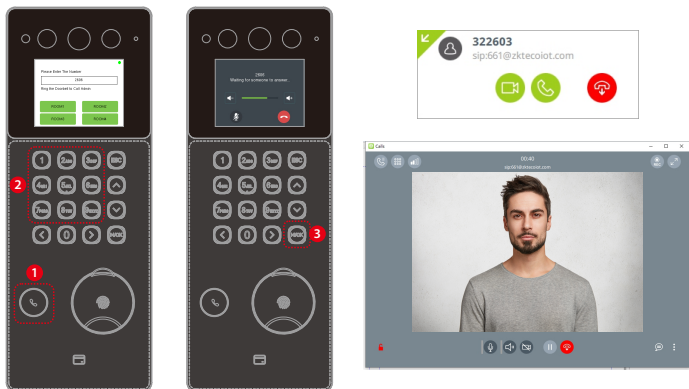

Two-way calls can be made between the device, indoor monitor, ZKBio Zexus App, and PC client (BioTalk Pro). For more details, please refer to the user manual.

ZKTeco Industrial Park, No. 32, Industrial Road,
Tangxia Town, Dongguan, China.

Phone : +86 769 - 82109991

Fax : +86 755 - 89602394

www.zkteco.com

