

# Installation Guide

---

2.4-inch Visible Light Terminal

Version: 1.1

## Installation Environment

Please refer to the following recommendations for installation.



KEEP DISTANCE



AVOID GLASS  
REFRACTION



AVOID DIRECT  
SUNLIGHT  
AND EXPOSURE



KEEP EFFECTIVE  
DISTANCE  
0.3-1.2m

## Device Installation

- ① Attach the mounting template sticker to the wall, and drill holes according to the mounting paper.
- ② Fix the backplate on the wall using wall mounting screws.
- ③ Attach the device to the backplate.
- ④ Fasten the device to the backplate with a security screw.

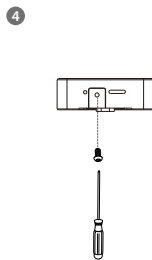
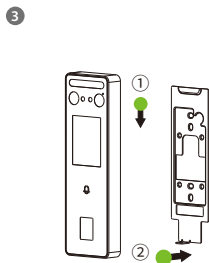
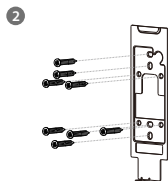
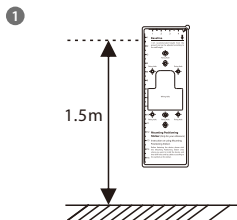

## Terminal Block

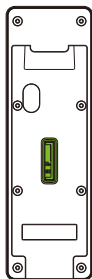

— BELL+	—
— BELL-	—
— ALARM+	—
— ALARM-	—

*Bell & Alarm*

— NC	—
— COM	—
— NO	—
— SEN	—
— GND	—
— BUT	—
— AUX	—
— GND	—

*Lock, Door Sensor,  
Exit Button &  
Auxiliary Input*

— WDO-OUT	—
— WDT-OUT	—
— INWD0	—
— INWD1	—
— GND	—
— 12V-OUT	—

*Wiegand*

— 485A	—
— 485B	—
— GND	—

*RS485*



## Power Connection

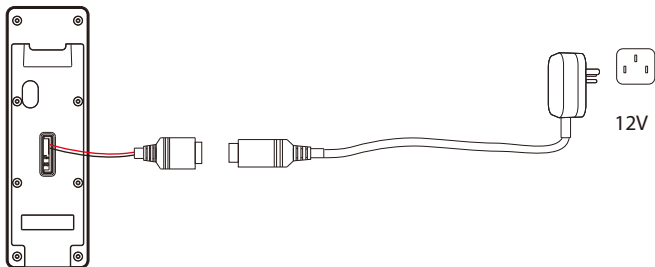

### Recommended AC Adapter

- 1) 12V  $\pm$  10%, at least 1500mA.
- 2) To share the power with other devices, use an AC Adapter with higher current ratings.

## Ethernet Connection

Connect the device and computer software over an Ethernet cable. As shown in the example below:

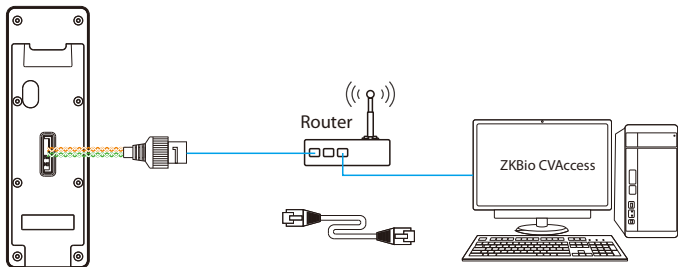

Default IP address: 192.168.1.201  
Subnet mask: 255.255.255.0

IP address: 192.168.1.130  
Subnet mask: 255.255.255.0

Click on [COMM.] > [Ethernet] to set the relevant parameters of network.

**Note:** In LAN, the IP addresses of the server (PC) and the device must be in the same network segment when connecting to the ZKBio CVAccess software.

## Wiegand Connection

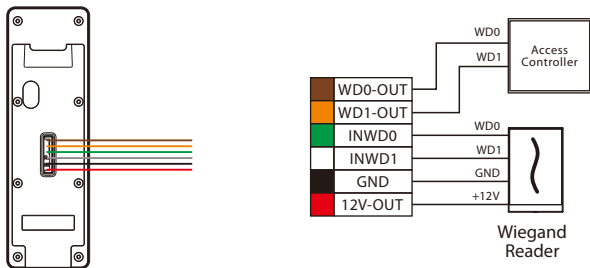

## RS485 Connection

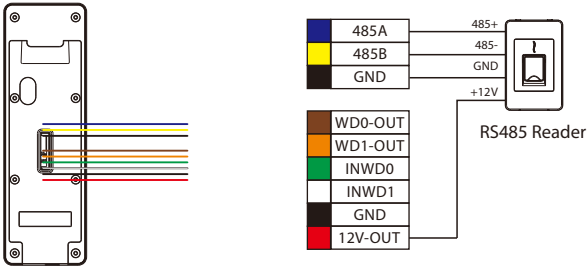

**Note:** 485A and 485B can be connected to the Barrier gate or the RS485 Reader, separately, but cannot be connected to the gate and reader at the same time.

## Door Sensor, Exit Button, Alarm & Auxiliary Connection

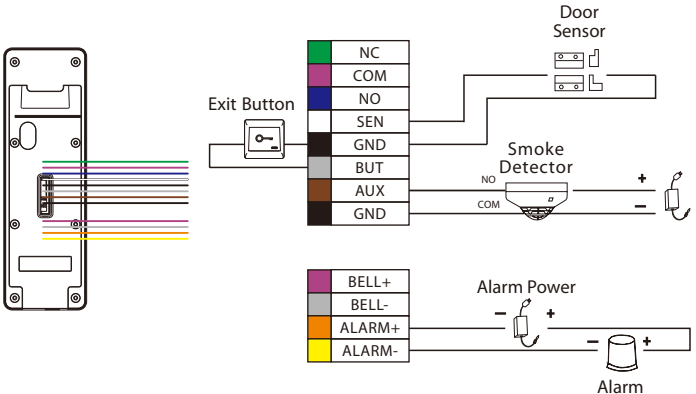

# Lock Relay Connection

The system supports **Normally Opened Lock** and **Normally Closed Lock**. The **NO LOCK** (normally unlocked when power-on) is connected with 'NO' and 'COM' terminals, and the **NC LOCK** (normally locked when power-on) is connected with 'NC' and 'COM' terminals. Take NC Lock as an example below:

## 1) Device not sharing power with the lock

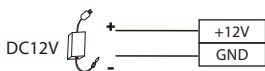

 Do not reverse the polarity.

Normally Closed Lock

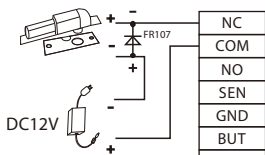

 Maximum 30V 3A input.

## 2) Device sharing power with the lock

